

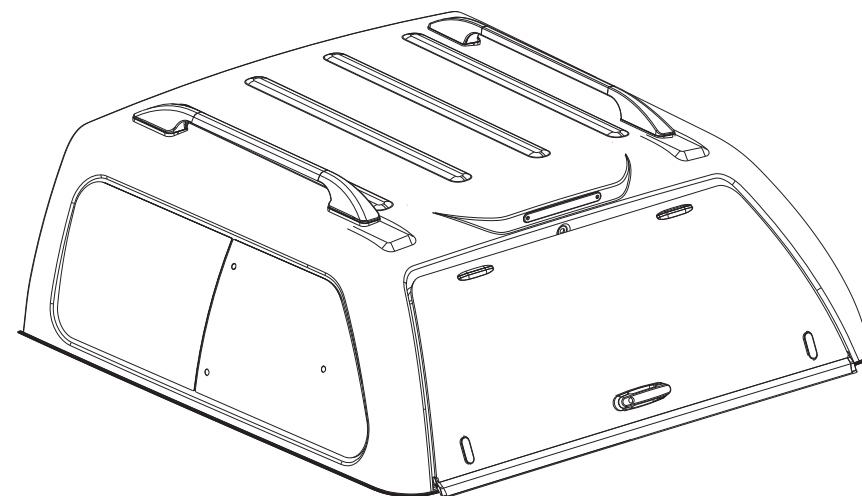

# INSTALLATION MANUAL CANOPY-ABS



## **FOR ENQUIRIES ON SERVICE :**

### **AUSTRALIA :**

AEROKLAS AUSTRALIA PTY., LTD.

1831-1833 Sydney Rd, Campbellfield, Vic, 3061

P: (03) 8339 0239 F: (03) 8339 0425 Email: [service-au@aeroklas.com](mailto:service-au@aeroklas.com)

### **UNITED KINGDOM :**

4X4 ACCESSORIES & TYRES LIMITED

Meridian Park, Leeming Bar, North Yorkshire, D17 9UJ, United Kingdom

Tel: +44 1677 42 55 55 Fax: +44 1677 42 56 66 E-mail: [mark@4x4at.com](mailto:mark@4x4at.com)

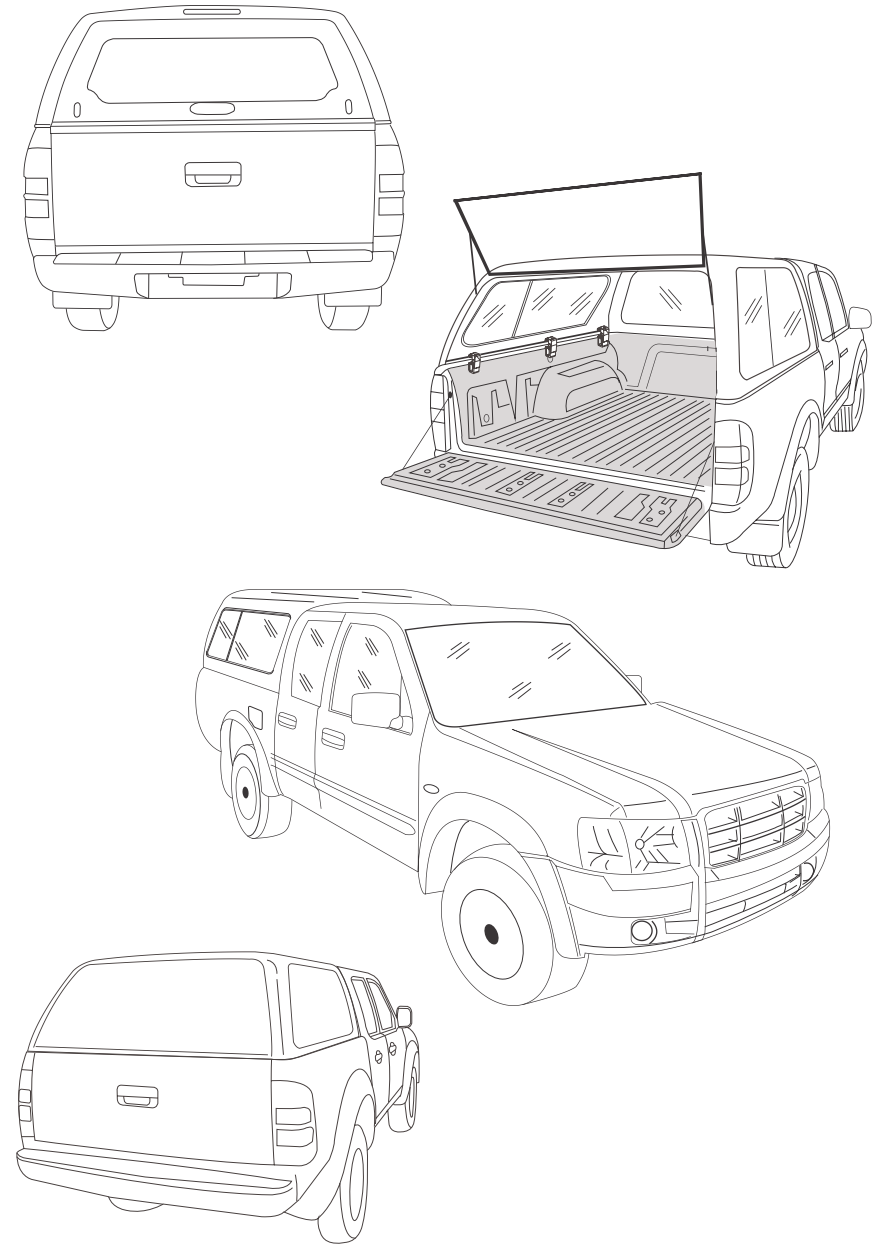

## OPTION #

6

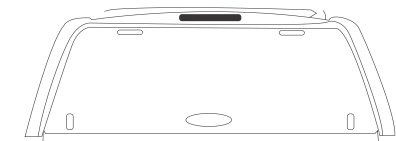
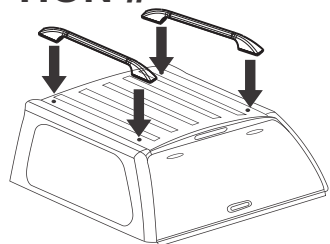

Max load 25 kg. (No Warranty)  
Max speed 140 Km/hr (90 Miles/hr)

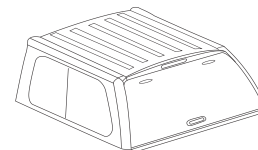
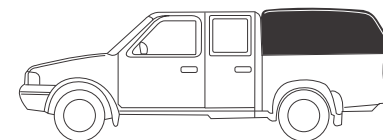
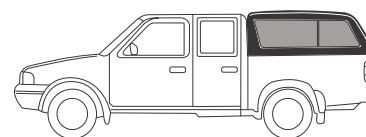
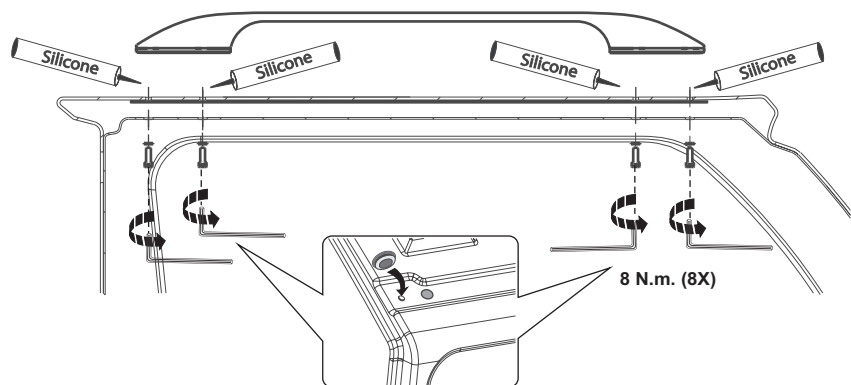
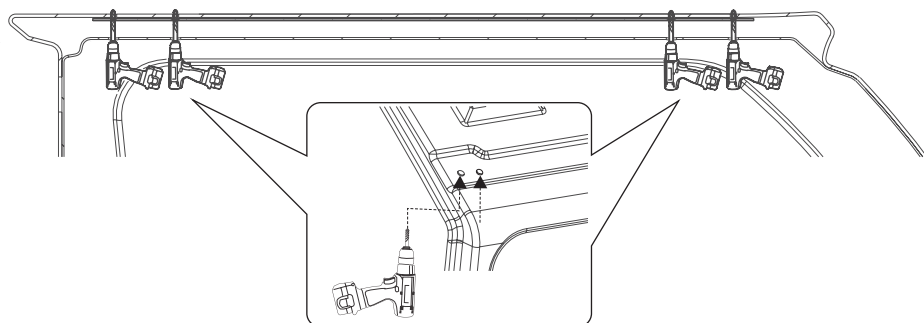
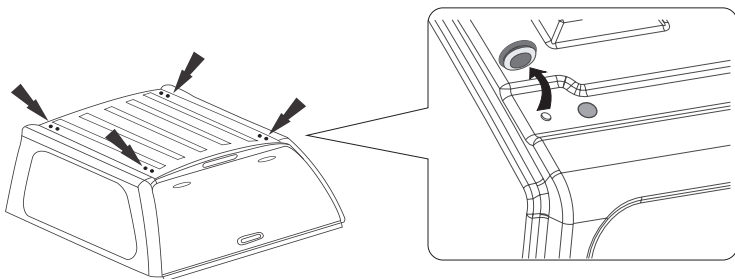

## OPTION #

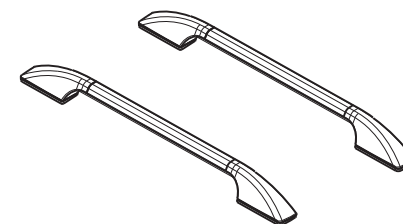

X1



X6



OPTIONAL

X6



X1

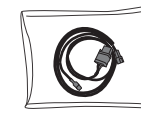

X1

(OPTIONAL FOR DEMISTER)



X2

50 mm.



No.10 No.5

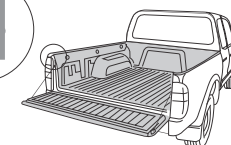
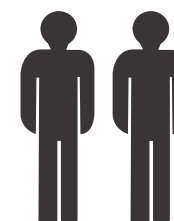
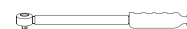

1 → 6

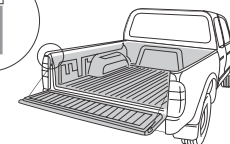

1 → 6

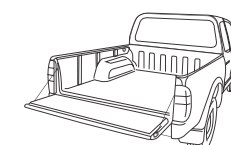

1 → 6

1.1

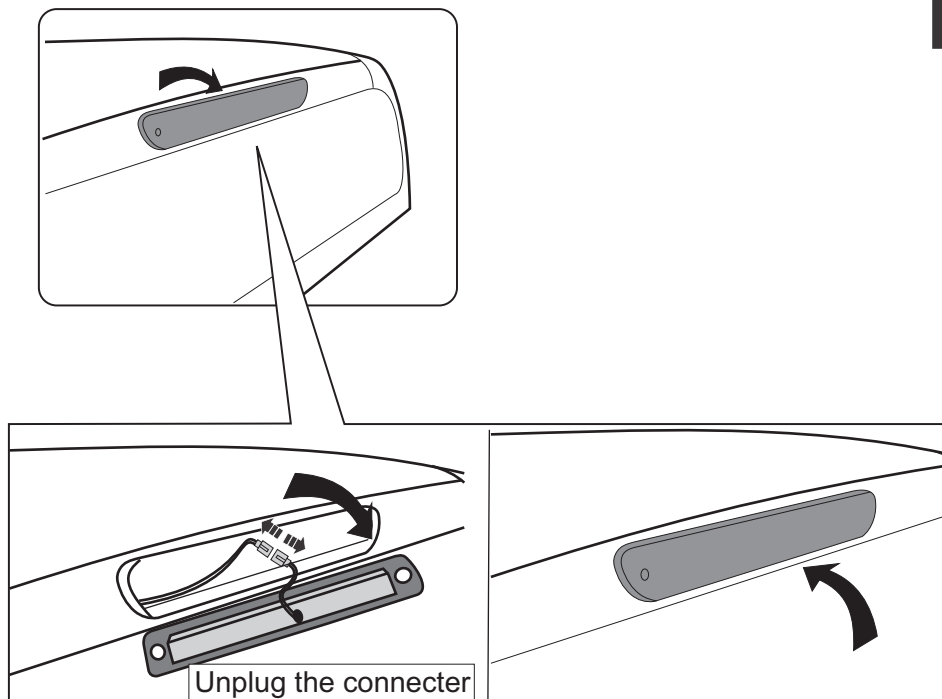

1.2

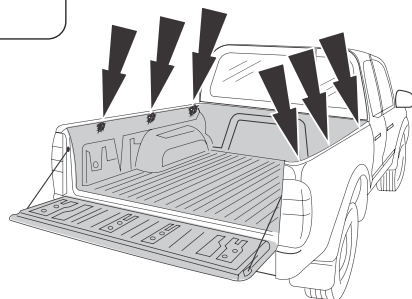
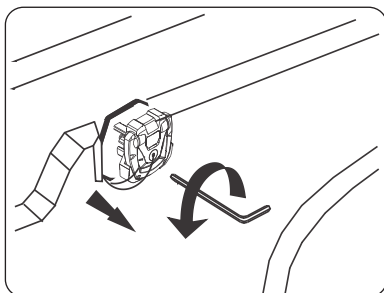

5.1

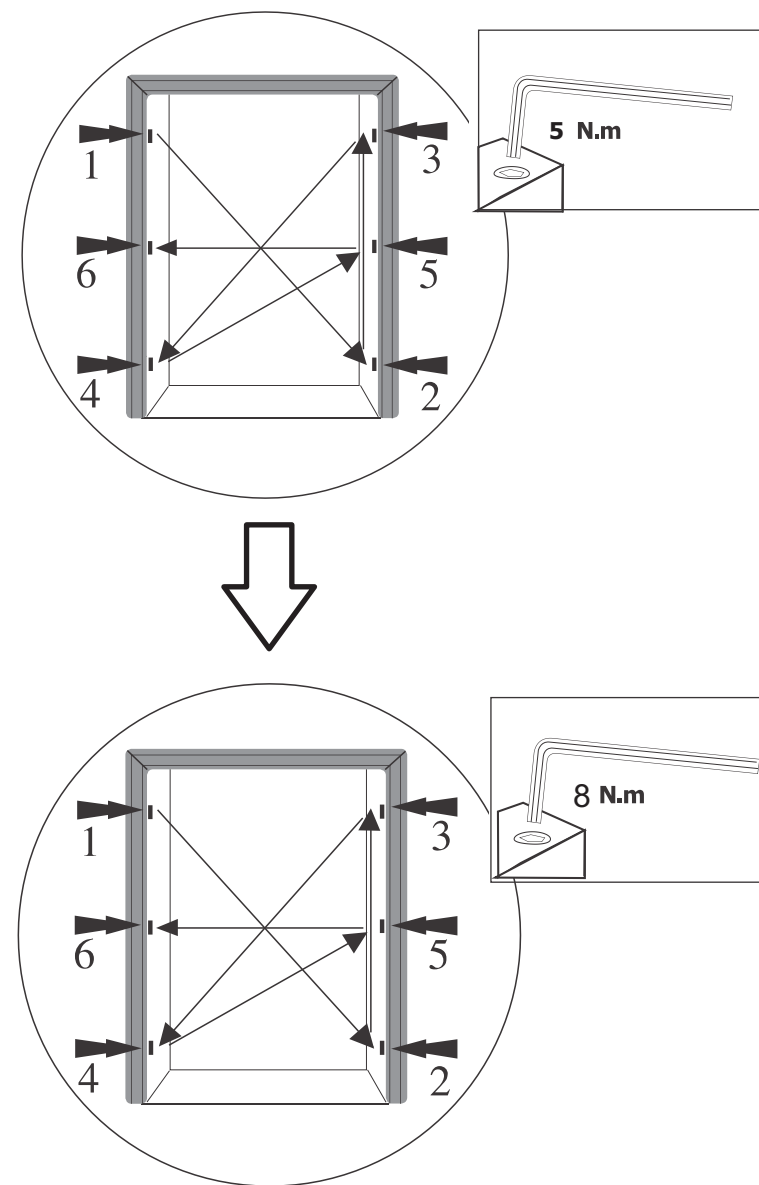

Note

- Apply LOCTITE 242/243 to the screws
- Re-tighten the screws 10 Nm every 1000 Km.

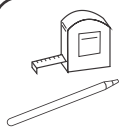

5

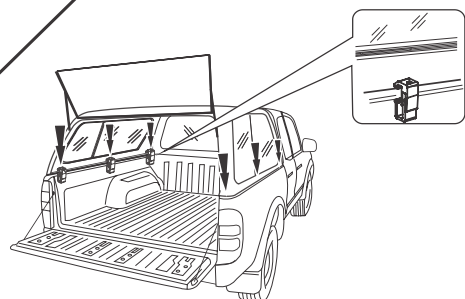
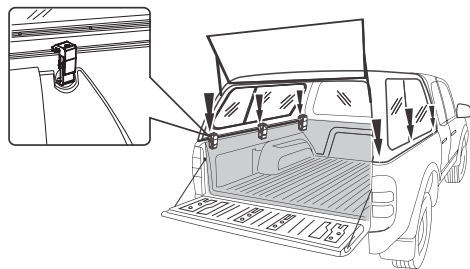
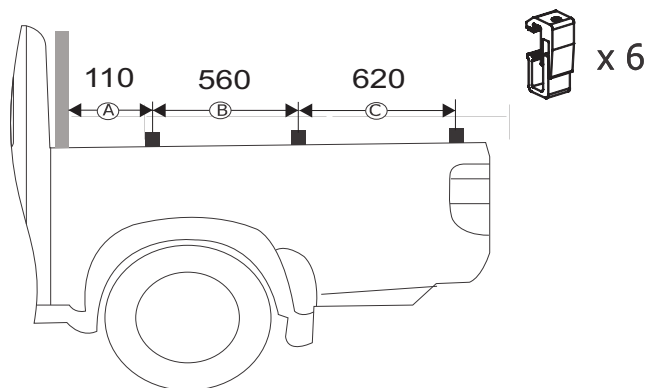

2

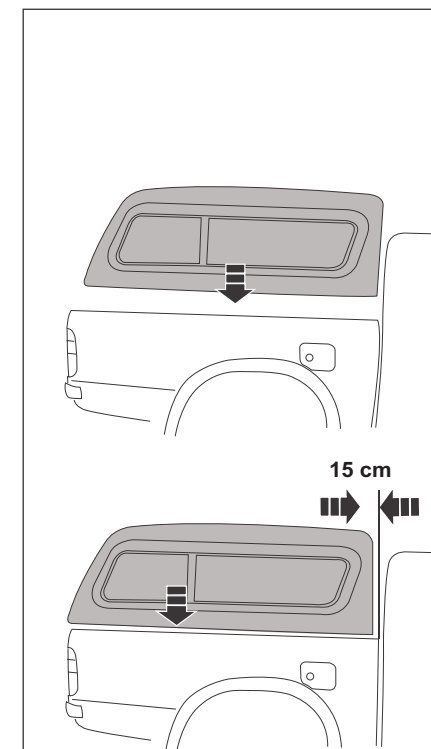
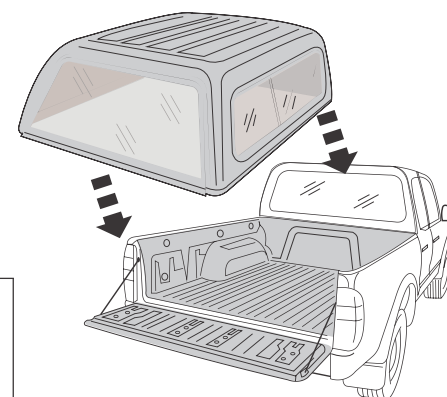
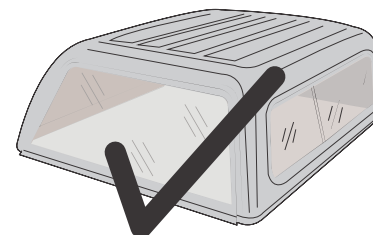
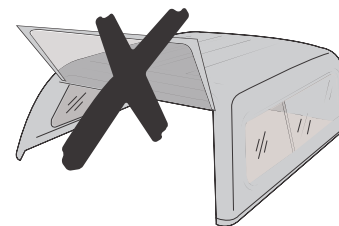
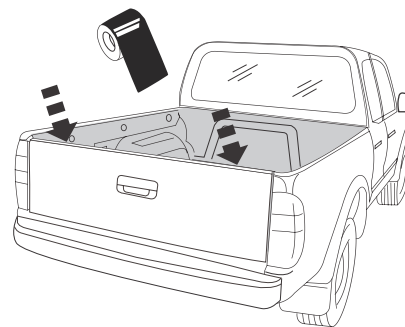

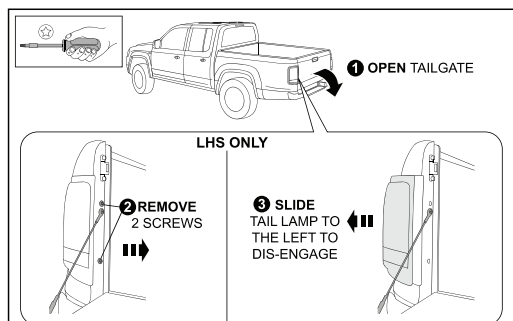

Diagram: 1 - REMOVE REAR LHS TAIL LAMP

Open the tailgate. Remove and retain the two (2) screws from the left hand side as shown securing the left hand side tail lamp, using a T30 torx drive screwdriver. Remove the tail lamp by sliding it to the left to dis-engage it from the ball fixings. (ref. diagram 1).

Disconnect the connector from the tail lamp

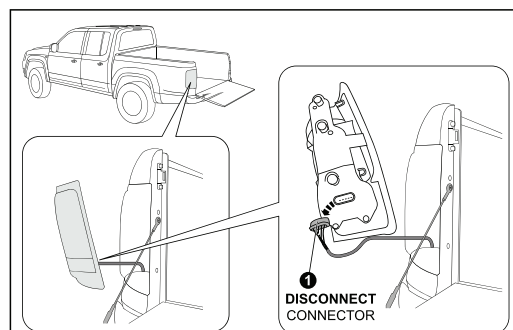

Diagram 2 DISCONNECT REAR LHS TAIL LAMP

Insert bypass tail lamp connector between the connector and the tail lamp and re-fit tail lamp to the vehicle by locating it on the ball fixings and sliding the tail lamp to the right. Secure to the vehicle with the two (2) screws previously removed. Close the tailgate. (ref. diagram 3).

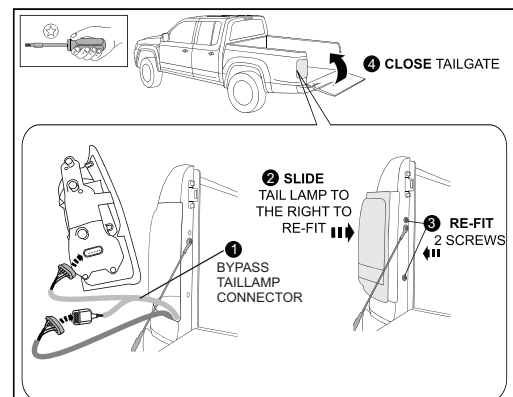
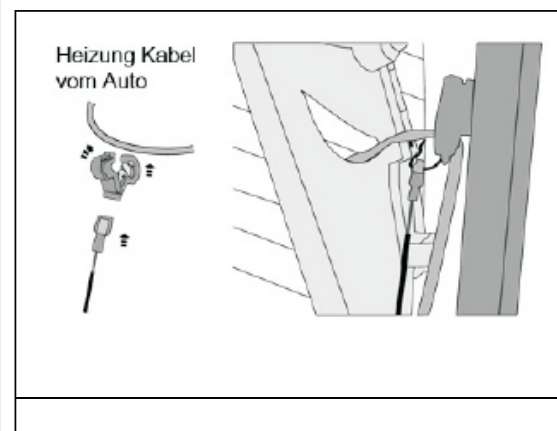
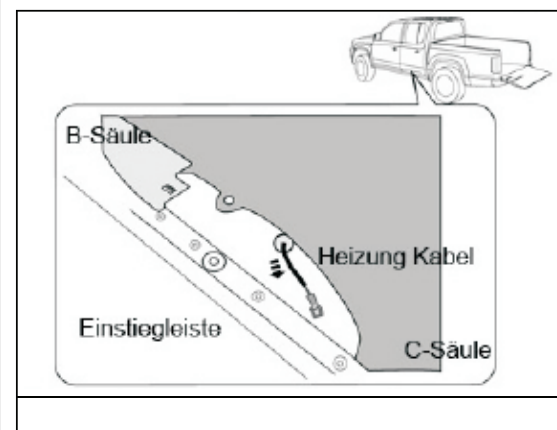
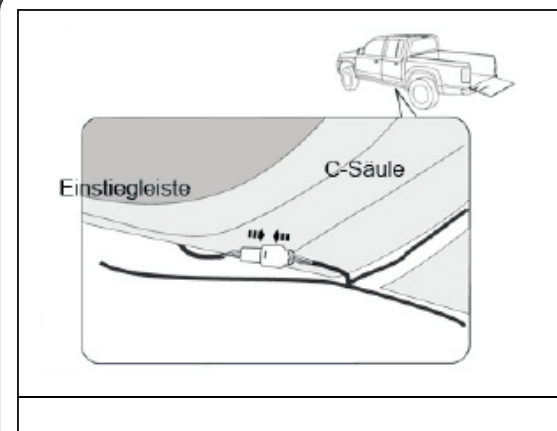
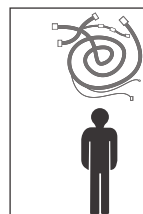
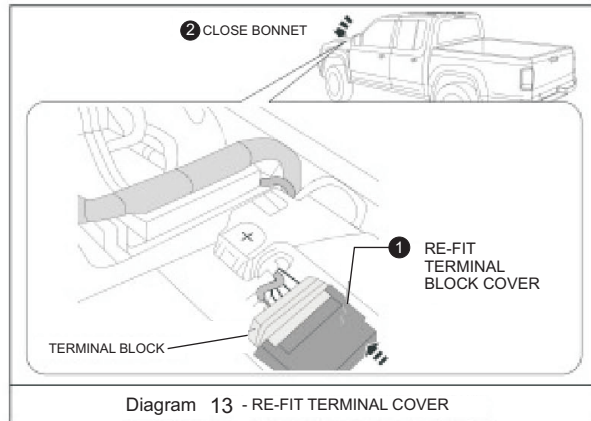
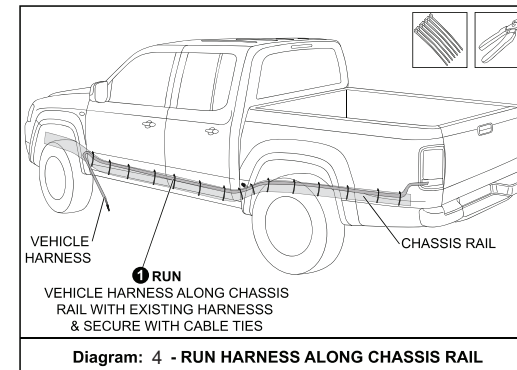
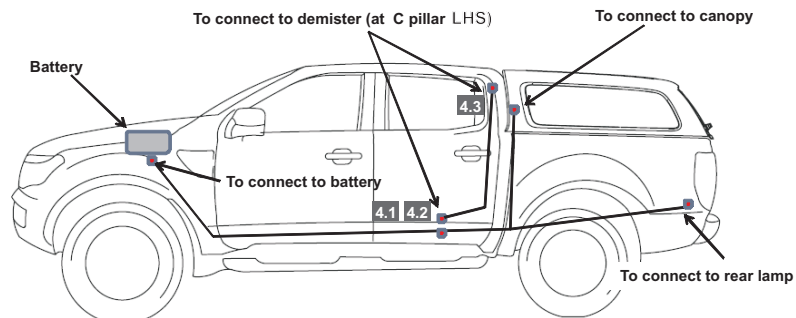
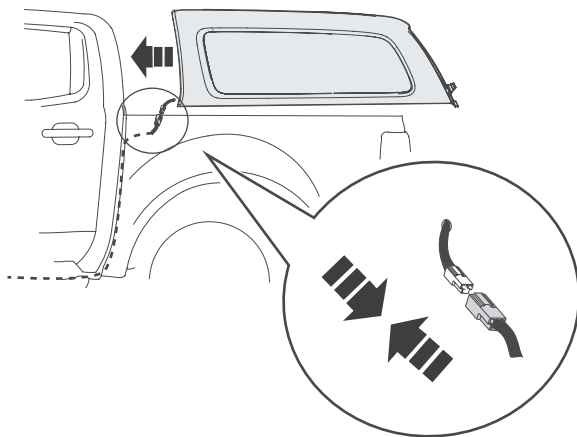

Diagram 3 CONNECT REAR LHS TAIL LAMP





Re-fit the terminal cover.  
Close the bonnet (ref. diagram 13).



Run the vehicle harness along the chassis rail with existing wiring, up to the front left hand wheel arch as shown. Fit cable ties to secure the vehicle harness to the existing harness every 300-400mm. Trim excess cable tie length with side cutters. Ensure harness is run in a direct route from the rear of the vehicle to the front. (ref. diagram 4).

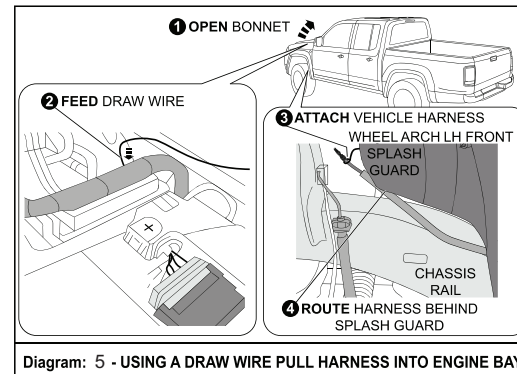

Open and secure the bonnet. Feed a draw wire down through the engine bay in the rear left hand corner where the inner left hand front quarter panel meets the firewall as shown. From inside the left hand front wheel arch, attach the end of the vehicle harness to the draw wire. Using two (2) people, one person feeding the vehicle harness and the second person to pull the draw wire until the harness is at the top of the engine bay. Ensure harness is positioned behind the splash guard inside the wheel arch as shown. Remove the draw wire. (ref. diagram 5). **IMPORTANT:** The wiring must be positioned against the firewall and avoid contact against any pipes or other wiring under tension of canopy vehicle wiring harness.

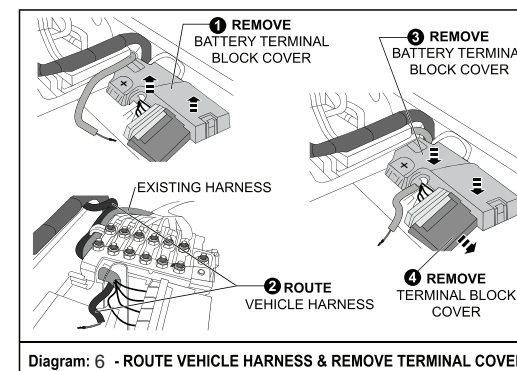

Remove battery terminal block cover using a flat blade screwdriver. Route the vehicle harness along side the existing harness under the battery terminal block cover to the terminal block as shown. Replace the battery terminal block cover. Remove terminal block cover carefully so you do not break the clipping tags. (ref. diagram 6).



3.7

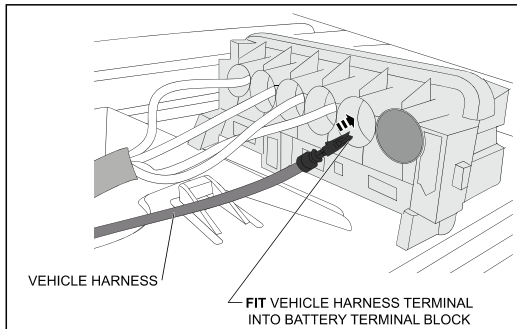

Diagram: 7 - CONNECT VEHICLE HARNESS TO TERMINAL

Fit the vehicle harness terminal into the Battery terminal block as shown. Terminal will go in one way only. When fitted correctly a 'CLICK' can be felt and heard, and you will not be able to pull the terminal out of the block. Pull terminal gently to ensure it can not be pulled out. (ref. diagram 7 ).

3.8

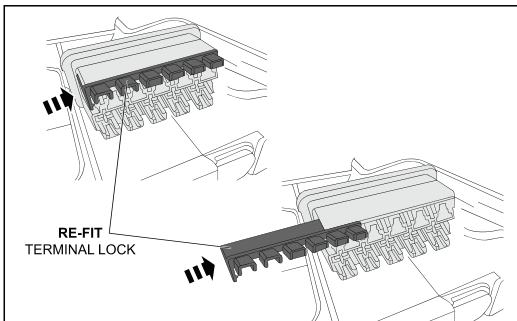

Diagram: 8 - RE-FIT TERMINAL LOCK TO BATTERY

Re-fit the terminal lock into the battery terminal block as shown. Ensure it is pushed all the way back in. (ref. diagram 8 ).

3.9

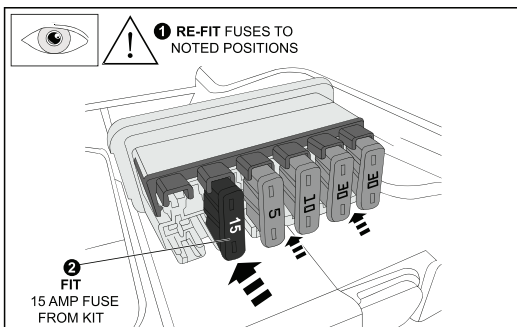

Diagram: 9 - RE-FIT FUSES &amp; FIT 15 AMP FUSE FROM KIT

Re-fit the fuses to previously noted positions. Fit the 15 amp fuse from the wiring harness hardware kit, to the vehicle harness terminal position as shown. (ref. diagram 9 ).

3.10

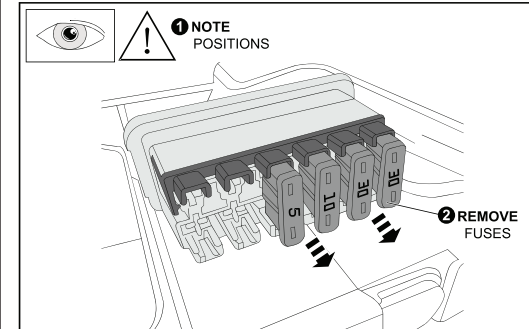

Diagram: 10 - NOTE POSITION OF FUSES &amp; REMOVE

**IMPORTANT: Note the positions of the fuses.**  
Remove fuses and store in a safe place to re-fit at a later stage. (ref. diagram10).

3.11

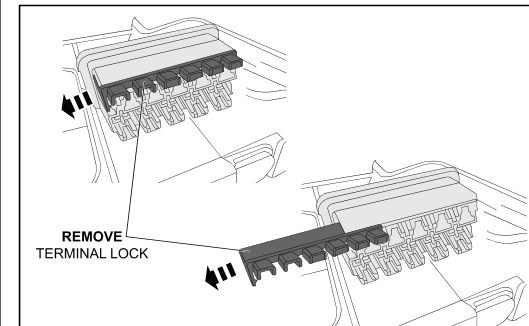

Diagram: 11 - REMOVE TERMINAL LOCK FROM BATTERY

Remove the terminal lock from the battery terminal block as shown. (ref. diagram11)

3.12

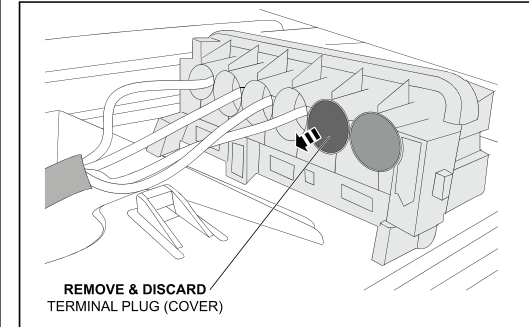

Diagram: 12 - REMOVE TERMINAL PLUG (COVER)

Using the sharp end of an engineers scribe, remove and discard the terminal plug (cover) from the battery terminal block as shown. (ref. diagram12).