

PowerLED4

LED LIGHTHEAD

E13 03 9922

E13 10R02 9916

11~30VDC



FEATURES

- High-Intensity 1W LED x 4
- Multi-Voltage Input 11~30VDC
- Built-in 19 Selectable Flash Patterns
- LEDs rated to 100,000 hours of operation.
- Non-volatile memory recalls last flash pattern used at power up.
- Multiple units are synchronizable and can flash simultaneously or alternately.
- Reverse polarity protection.
- Weatherproof and vibration resistant design for external or internal use.
- Aluminum base for heat dissipation.

SPECIFICATIONS

Meets: SAE, Title XIII, e13, E13

Bulb: 1W LED x 4pcs

Warning Patterns: 19 Flash Patterns

Operating Voltage: 11~30VDC

Avg. Current: 0.28A@12.8VDC 0.15A@24VDC
(varies with flash pattern)

Avg. Power: 3.6 Watts (varies with flash pattern)

Max. Current: 0.56A@12.8VDC 0.3A@24VDC

Max. Power: 7.2 Watts

Wires: Red-Vcc: 20cm (20AWG)

Black-GND: 20cm (20AWG)

Yellow-Flash Patterns & Sync: 20cm (20AWG)

White-Phase: 20cm (20AWG)

Fuse Recommend: 3A

Multi-Unit Synchronization: Over 15

Storage Temperature: -40°C to +75°C

Operating Temperature: -30°C to +65°C

Available in: RED, BLUE, AMBER, WHITE

DIMENSIONS

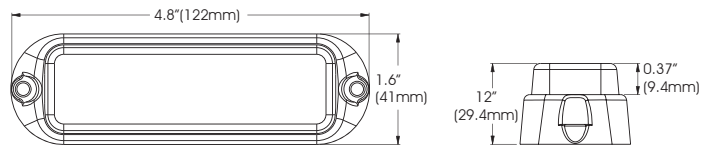

FLASH PATTERN

Momentarily apply +VDC to YELLOW wire:

- once for next pattern
- quickly three times for reset

FP#	Flash Patterns		
0	Random (default)	10	Double (all)
1	Single (split)	11	Quad (all)
2	Double (split)	12	Quint (all)
3	Quad (split)	13	Mega (all)
4	Quint (split)	14	Ultra (all)
5	Mega (split)	15	Single-Quad (all)
6	Ultra (split)	16	Single H/L (all)
7	Single-Quad (split)	17	Steady 2 (california)
8	Single H/L (split)	18	Steady 4 (all)
9	Single (all)		

NOTE: This unit may not be factory set at pattern 0